



## External Serial Print Server Quick Setup Guide

---



# Codewriter Installation Process

This procedure assumes that the user is familiar with configuring network peripherals, as well as installing and setting up printers.

1. Connect the network's cable to the RJ-45 network interface connection on the **Serial Print Server**.
2. Connect the Power Supply cable to the Serial Print Server. Plug the power supply transformer into the AC outlet.
3. Plug one side of the RJ-45 cable into the DB-25 adapter (Blue). Then plug in the DB-25 adapter (Blue) into the serial interface port on the Codewriter.
4. Plug the DB-9 adapter (Green) into the other end of the RJ-45 cable and plug the adapter (Green) into the Serial Print Server.
5. Begin the network print server configuration process. See the Serial Server CD for setting up and addressing the Serial Print Server.

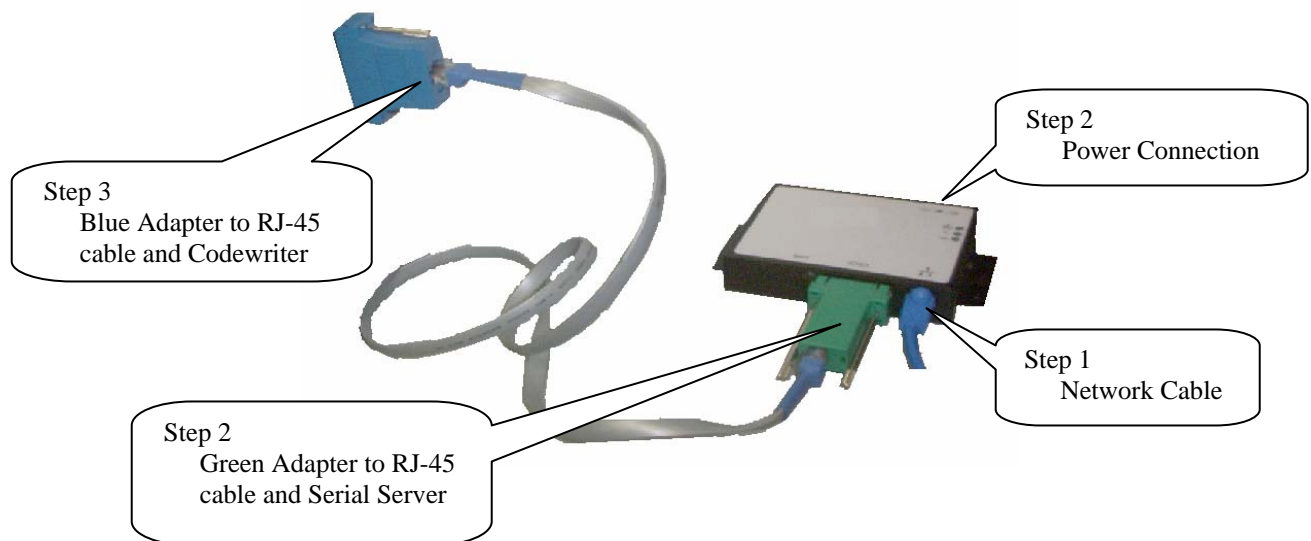

## Configuring the Codewriter Communications

6. Once the Serial Print Server is configured for the attached network, access the serial port configuration features and determine the values of the following serial print server features:

Baud Rate: \_\_\_\_\_ Data Bits: \_\_\_\_\_

Parity: \_\_\_\_\_ Handshaking: **Hardware (RTS/CTS)**

7. Using the Codewriter's Setup Menus, verify that the communication parameters match the serial server parameters (See the Codewriter's User Manual for instructions on accessing and changing features).

**Note:** It is recommended that you set the printer and the Serial Print Server to **Hardware (RTS/CTS)** handshaking.

# Documax or Accel 63xx/53xx Installation Process

This procedure assumes that the user is familiar with configuring network peripherals as well as installing and setting up printers.

1. Connect the network cable to the RJ-45 network interface connection on the **Serial Print Server**.
2. Connect the Power Supply cable to the Serial Print Server. Plug the power supply transformer into the AC outlet.
3. Plug one side of the RJ-45 cable into the DB-25 adapter (Gray). Then plug in the DB-25 adapter (Gray) into the serial interface port on the Documax or Accel.
4. Plug the DB-9 adapter (Green) into the other end of the RJ-45 cable and plug the adapter (Green) into the Serial Print Server.
5. Begin the network print server configuration process. See the Serial Server CD for setting up and addressing the Serial Print Server.

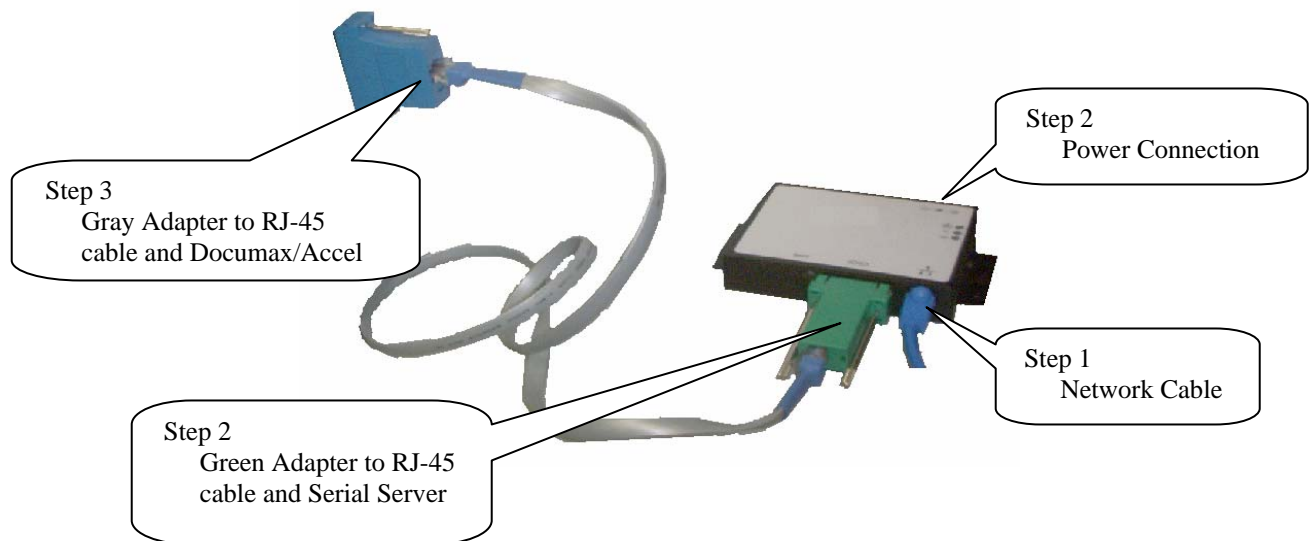

## Configuring the Documax Communications

6. Once the Serial Print Server is configured for the attached network, access the serial port configuration features and determine the values of the following serial server features:

Baud Rate: \_\_\_\_\_ Data Bits: \_\_\_\_\_

Parity: \_\_\_\_\_ Handshaking: **Xon/Xoff**

7. Using the Documax or Accel Setup Menus, verify that the communication parameters match the serial server parameters (See the printer's User Manual for instructions on accessing and changing features).

**Note:** It is recommended that the printer and the Serial Print Server are set for **Xon/Xoff** handshaking.

# Fastmark 400/600/4000/6000 printers Installation Process

This procedure assumes that the user is familiar with configuring network peripherals as well as installing and setting up printers.

1. Connect the network cable to the RJ-45 network interface connection on the **Serial Print Server**.
2. Connect the Power Supply cable to the Serial Print Server. Plug the power supply transformer into the AC outlet.
3. Plug one side of the RJ-45 cable into the DB-9 adapter (Black). Then plug in the DB-9 adapter (Black) into the serial interface port on the Fastmark.
4. Plug the DB-9 adapter (Green) into the other end of the RJ-45 cable and plug the adapter (Green) into the Serial Print Server.
5. Begin the network print server configuration process. See the Serial Print Server's CD for setting up and addressing the **Serial Print Server**.

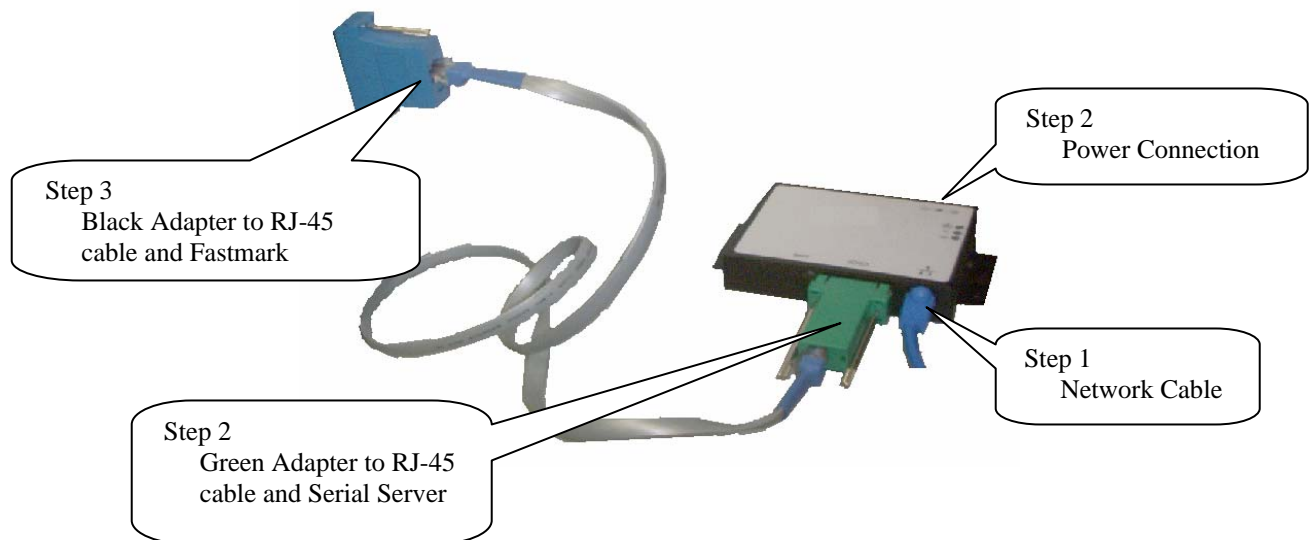

## Configuring the Fastmark Communications

6. Once the Serial Print Server is configured for the attached network, access the serial port configuration features and determine the values of the following serial server features:

Baud Rate: \_\_\_\_\_ Data Bits: \_\_\_\_\_  
 Parity: \_\_\_\_\_ Handshaking: **RTS/CTS**

7. Using the Fastmark Setup functions, verify that the communication parameters match the serial server parameters (See the printer's User Manual for instructions on accessing and changing features). Handshaking should be **RTS only** in both the serial server and the printer.

### Fastmark PAL printers that require the uses of the Feature Manager Program

1. The following communications parameters are required by the FeatureMan program. These settings have to be set in the **Serial Server** before attempting to use the FeatureMan program.

Baud Rate: **57,600** Data Bits: **8**  
 Parity: **None** Handshaking: **None**

2. Once the above **Serial Server** communications parameters have been changed, FeatureMan can now be used.
3. At the conclusion of setting up the printer using FeatureMan, set RTS/CTS handshaking in the **Serial Server's** setup menus. Make sure that **RTS only** handshaking is set in the PAL printers.
4. If the Printer's Setup Mode can not be accessed using FeatureMan:
  - Verify that the Handshaking parameter in the serial server is set and saved to **NONE**. This may require that the power on the serial server to be cycled (off then on).
  - Verify that the serial servers Baud Rate, Parity, and Data Bits are set to the FeatureMan required values.
  - Verify that the printer is in FeatureMan mode.